

AGENDA PLACEMENT FORM

(Submission Deadline – Monday, 5:00 PM before Regular Court Meetings)

Date: 10/27/2023
Meeting Date: 11/13/2023
Submitted By: Ralph McBroom
Department: Purchasing
Signature of Elected Official/Department Head:

<p>Court Decision: This section to be completed by County Judge's Office</p> <p>COMMISSIONERS COURT</p> <p>NOV 13 2023</p> <p>Approved</p>
--

Description:

Consider and approve award of RFQ 2024-001 for Johnson County 911 Call Center Consoles to Watson Furniture Group under Cooperative NCPA 07-64 in the amount of \$325,817 using American Rescue Plan Act (ARPA) Funds.

(May attach additional sheets if necessary)

Person to Present: Ralph McBroom

(Presenter must be present for the item unless the item is on the Consent Agenda)

Supporting Documentation: (check one) PUBLIC CONFIDENTIAL

(PUBLIC documentation may be made available to the public prior to the Meeting)

Estimated Length of Presentation: 5 minutes

Session Requested: (check one)

Action Item Consent Workshop Executive Other _____

Check All Departments That Have Been Notified:

County Attorney IT Purchasing Auditor
 Personnel Public Works Facilities Management

Other Department/Official (list) _____

**Please List All External Persons Who Need a Copy of Signed Documents
In Your Submission Email**

INFORMAL BIDS TABULATION FORM 2024-001



INSTRUCTIONS FOR COMPLETION:

- 1) Per Policy, purchases from \$10,000 and \$49,999.99 require at least two (2) vendor quotes.
- 2) Vendor quotes must be in writing (i.e. Vendor Quotation form; Vendor email; Internet Quote, etc.).
- 3) All awards should be made to the vendor whose proposal offers the "best value" to Johnson County.
- 4) Awards based on "best value" may consider various factors, including but not limited to:
 - (a) Price / Total Cost of Ownership, (b) Product/Service Quality, (c) Availability, (d) Vendor/Product Reputation, (e) Vendor's Ability to Meet County Needs, (f) Client References, (g) Past Experience with the County, and/or (h) any other relevant factor that ensures best value to the County, (i) Warranty.
- 5) Upon consideration of all factors, if all bids meet the County needs, the award should be made to the lowest bidder.

Informal Bids Tabulation Summary				Option #1		Option #2		Option #3		Option #4		Option #4					
				Vendor Name:		Quoted By (Contact Name):		Enter "X" for selected vendor									
PRODUCT/SERVICE DESCRIPTION				ITEM	QTY	UNIT OF MEASURE	UNIT PRICE	EXTENDED PRICE	UNIT PRICE	EXTENDED PRICE	UNIT PRICE	EXTENDED PRICE	UNIT PRICE	EXTENDED PRICE			
14 ea -Climate Controlled 911 Dispatch Workstations including Technology Cabinets & All Required Installation & Implementation Hardware.				1	1	ea	\$276,213.12	\$276,213.12	\$351,206.00	\$351,206.00	\$273,525.20	\$273,525.20		\$0.00	\$0.00		
Installation				2	1	ea	\$40,764.00	\$40,764.00	\$61,045.00	\$61,045.00		\$54,750.00		\$0.00	\$0.00		
				3		ea		\$0.00		\$0.00		\$0.00		\$0.00			
				4		ea		\$0.00		\$0.00		\$0.00		\$0.00			
				5		ea		\$0.00		\$0.00		\$0.00		\$0.00			
				6		ea		\$0.00		\$0.00		\$0.00		\$0.00			
				7		ea		\$0.00		\$0.00		\$0.00		\$0.00			
				8		ea		\$0.00		\$0.00		\$0.00		\$0.00			
				9		ea		\$0.00		\$0.00		\$0.00		\$0.00			
				10		ea		\$0.00		\$0.00		\$0.00		\$0.00			
				11		ea		\$0.00		\$0.00		\$0.00		\$0.00			
				12		ea		\$0.00		\$0.00		\$0.00		\$0.00			
* DISCLOSURE NOTICE: By signing below, I hereby certify that all quotes recorded include all the firms that have been contacted for bids and their replies are reflected accurately on this form.				SUBTOTAL				\$316,977.12		\$412,251.00		\$328,275.20		\$0.00	\$0.00		
				SHIPPING COST				\$8,840.00		\$9,832.00		\$21,250.00					
				TOTALS				\$325,817.12		\$422,083.00		\$349,525.20		\$0.00		\$0.00	
Warranty				Lifetime Furn./10 yr. Electronics		Lifetime Furn./10 yr. Electronics		10 yr. All Components									
F.O.B. SHIPPING TERMS				Destination		Destination		Destination									
DELIVERY DATE				8-10 Weeks From Order		8-10 Weeks From Order		10-12 Weeks From Order									

All awards should be made based on "Best Value" to the County. Please write a short summary below of why the vendor chosen is the best value if it is not the lowest bid.

* Name of Person Completing this Form: Lance Anderson * Signature: _____

NOTE: THE COMPLETED & SIGNED TABULATION FORM AND COPIES OF ALL QUOTES MUST BE ATTACHED TO THE PURCHASE REQUISITION.



Johnson County, Texas

Project Location: CLEBURNE TX 76031
Contact Name: Keysha Hill
Phone Number: 8175566099
Email Address: keysha@johnsoncountytexas.org

Watson Rep Firm: Access Marketing
Watson Sales Rep: Jeff McClain
Phone Number: 316-512-9022

Project Summary: 14 Mercury Pro Worksurfaces

NCPA 07-64

All Positions Include:

- 96"W Pro Worksurface – Height-Adjustable with Depth Adjustment, OPTIONAL Environmental Control and OPTIONAL In-Dash Power
- (Optional) Environmental Control: Forced Air Heat, Cooling Fans, LED Ambient Lighting and Dimmable LED Task Lighting
- (Optional) In-Dash Power: 2 Power Outlets
- Dual Tier Monitor Array – Height-Adjustable with Individually Adjustable Monitor Arms: 3 over 3
- Technology Bridge Storage to Accommodate up to (3) Mid Tower PCs No Larger Than 15.75"D x 7"W x 15"H and Technology Cabinet to Accommodate up to (4) Full-Tower PCs
- Screens – 42"H Fabric
- Accessories – (OPTIONAL) Grounding Bar, Red / Yellow / Green Status Light with 12"H Pole, Pendant Drawer
- (OPTIONAL) Technology Ports Per Position - (8) USB-A Data I (1) Dual USB-A Charging I (2) RJ45/CAT6 I (4) 35mm Audio

Finish Selection: Unselected

Installation:

- Type of Site – Empty room
- Pre-Installation Site Prep – None
- Location – 1st Floor
- Prevailing Wage or Union – No
- Additional Information – None

Quote Date: 10/20/2023 **Quote Expiration** 1/20/2024 **Quote Revision:** 11 **Watson Account Manager:** Kelsey Hoskins

Terms and Conditions

Drawings and Floorplans

It is necessary that accurate room dimensions and features are provided to Watson for space planning and installation. Watson commits to providing product symbols that are correct in size. It is the responsibility of the customer to verify that the room dimensions and features provided to Watson are accurate prior to submitting a purchase order.

All purchase orders must be accompanied by the drawing and quote that has been approved for manufacture. Watson quotes are valid 90 days from the date of issue.

Purchase Orders and Order Acknowledgments

Purchase orders should be submitted via email to:
orders@watsonfg.com

All purchase orders must include the following information:

- Sold-to information including billing address and contact name with email and phone number
- Ship-to information including installation address and contact name with email and phone number
- Purchase order number
- Order total
- Final finish selections
- Approved final drawing and quote for manufacture (proposal and revision number must match across all pages)
- Requested delivery / installation date

Any omission may result in the delay of processing the order. All quotations, acknowledgments, and invoices are subject to corrections for errors or omissions.

All orders and subsequent change orders must be in writing. Watson will issue an acknowledgment of the order that includes estimated delivery date. The acknowledgment is the final agreement between Watson and the customer.

Order Cancellations and Changes

Acknowledged orders may not be changed or canceled, in whole or in part, without prior written consent of Watson.

Orders for which production has started may not be canceled. Orders that include non-standard products and non-standard finishes may not be canceled. In the event of cancellations prior to the start of production, for standard products, the customer will be liable for cancellation charges of 25% of the order total.

Any approved order change will require the customer to resubmit the approved final drawing and quote reflecting the requested change. An order change may affect the delivery date. Expenses incurred because of order changes will be charged to the customer.

Taxes

All sales, use, excise, and other applicable taxes are the purchaser's responsibility and will be invoiced to the purchaser. If purchaser claims an exemption from such taxes, it shall be the purchaser's responsibility to furnish an appropriate exemption certificate at the time the order is placed.

Payment Terms

Orders are invoiced at time of shipment. Standard payment terms are 50% due at time of order and 50% due before shipment.

When credit is extended for net thirty 30 days, payment is due within 30 days of shipment. Past due accounts will be charged the lesser of 1-1/2% per month or the highest rate permitted by law plus all collection costs, including reasonable attorney's fees and expenses.

Credit card payments are accepted up to \$5,000. Payments above that amount can be made by check or ACH.

Freight

Freight will be quoted on a per project basis considering destination location, order size and weight as well as the current freight market. Watson Console freight terms are FOB destination to all 50 US States.

Charges incurred by Watson complying with non-standard shipment requests such as inside delivery, expediting, redelivery, weekend delivery, unpacking, straight trucks, specific driver requests or temporary holding will be invoiced to the purchaser. Risk of loss shall pass to purchaser at the time Watson places the product(s) in the possession of a common carrier or at the time of delivery to the purchaser in the case of delivery by Watson vehicles.

Freight Claim

We'll file the freight claim on your behalf. But to do that - we'll need your help.

FREIGHT DAMAGE: It is the customer's responsibility to examine products upon receipt, note the damage or shortage on the bill of lading, and to notify Watson within 24 hours of delivery. Failure to provide notice within 24 hours constitutes acceptance of the product.

CONCEALED DAMAGE: Claims must be made by the customer in writing and with photographs within five (5) business days after delivery. Failure by the customer to make any concealed damage claim within five (5) business days constitutes acceptance of the product and a waiver of any apparent damages.

Storage

We understand that projects sometimes face unforeseen delays. If the request to move an order out is received more than 25 business days prior to the acknowledged ship date, we can likely accommodate that request without additional cost. If the request to move an order out is received less than 25 business days prior to the acknowledged ship date, customers may opt to contract storage with Watson for up to 30 days post-ship date. Watson charges a storage fee of \$1 per day per \$1,000 of the total order invoice. The minimum storage fee is \$250. When storage occurs, we will consider that the product has been delivered to the customer for all purposes, and invoicing will occur. Costs for storage will be subsequently invoiced to the customer.

Force Majeure

Watson shall not be liable for any loss, damage, or delay resulting from forces beyond its reasonable control including fire, flood, strike or other labor difficulty, act of God, or due to any cause beyond its reasonable control. In the event of any such delay, delivery will be postponed by such length of time as may be reasonably necessary to accommodate for the delay.

Governing and Binding Terms

Watson's Terms and Conditions supersede provisions in a customer Agreement only to the extent that these terms are not covered by the customer Agreement.

Project

Johnson County, Texas

Proposal 1

Quote Revision: 11

Quote Date: 10/20/2023

Drawn By: KH

Watson Sales Rep

Jeff McClain

Watson Account Manager

Kelsey Hoskins

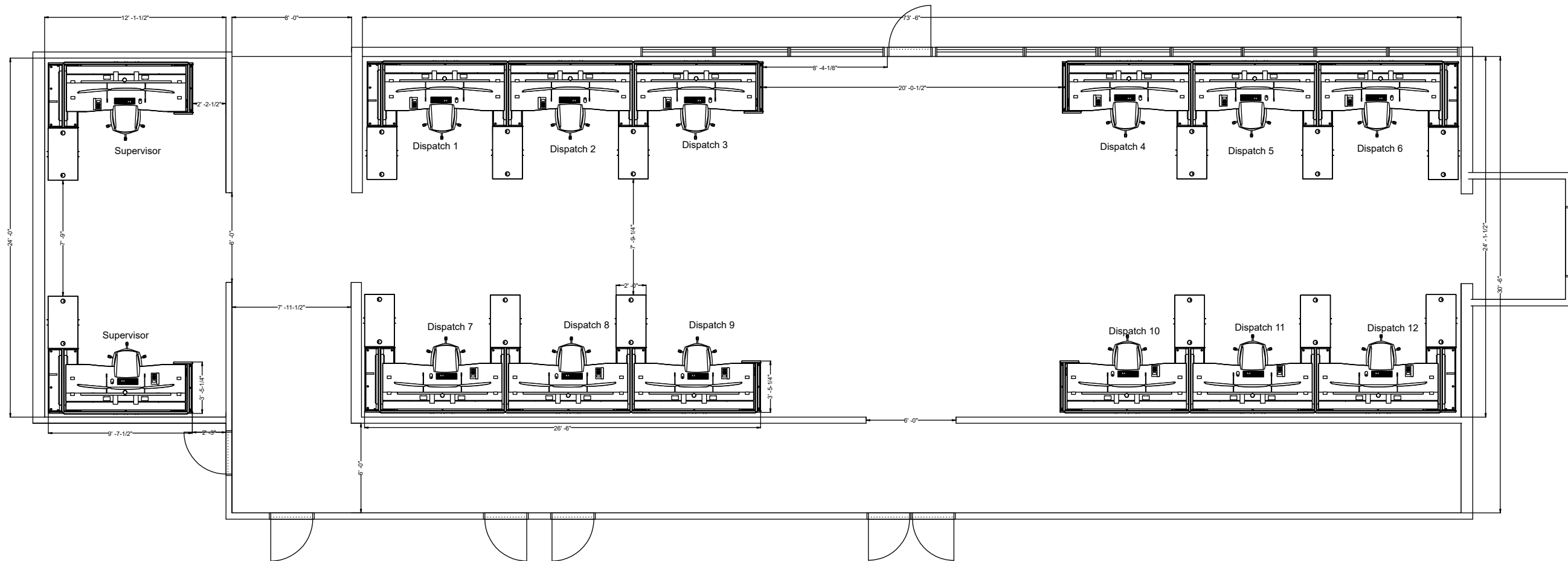

Project

Johnson County, Texas

Proposal 1

Quote Revision: 11
Quote Date: 10/20/2023
Drawn By: KH

Watson Sales Rep

Jeff McClain

Watson Account Manager

Kelsey Hoskins

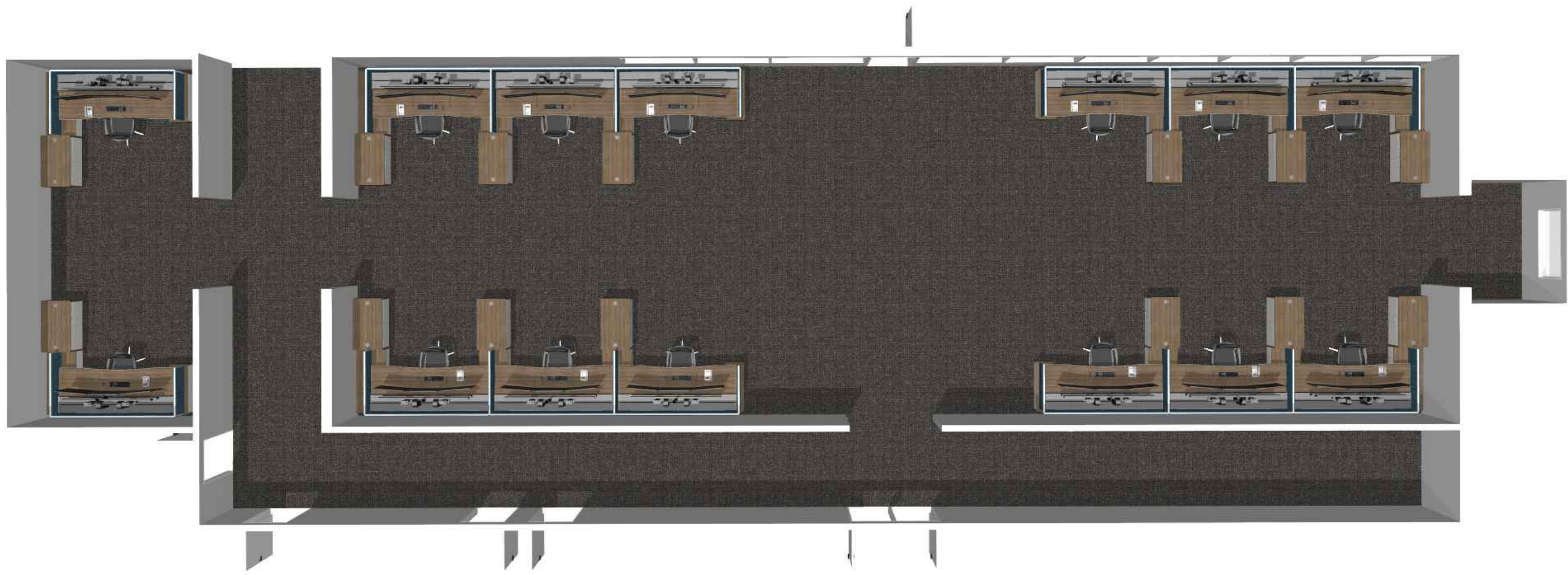

Full Room 3D



**watson
consoles**

26246 Twelve Trees Lane NW
Poulsbo, WA 98370
www.watsonconsoles.com 360.394.1300
© 2022 Watson Furniture Group, Inc. All Rights Reserved

Project

Johnson County, Texas

Proposal 1

Quote Revision: 11
Quote Date: 10/20/2023
Drawn By: KH

Watson Sales Rep

Jeff McClain

Watson Account Manager

Kelsey Hoskins

Project

Johnson County, Texas

Proposal 1

Quote Revision: 11
Quote Date: 10/20/2023
Drawn By: KH

Watson Sales Rep

Jeff McClain

Watson Account Manager

Kelsey Hoskins



Full Room 3D

Project

Johnson County, Texas

Proposal 1

Quote Revision: 11

Quote Date: 10/20/2023

Drawn By: KH

Watson Sales Rep

Jeff McClain

Watson Account Manager

Kelsey Hoskins

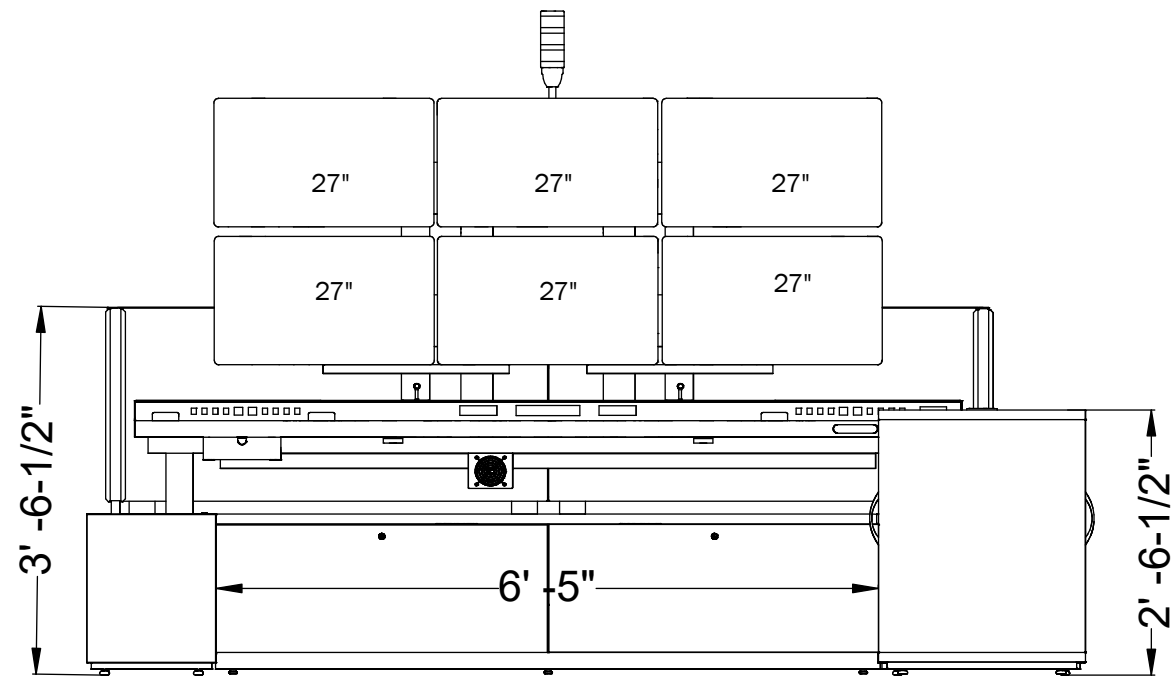
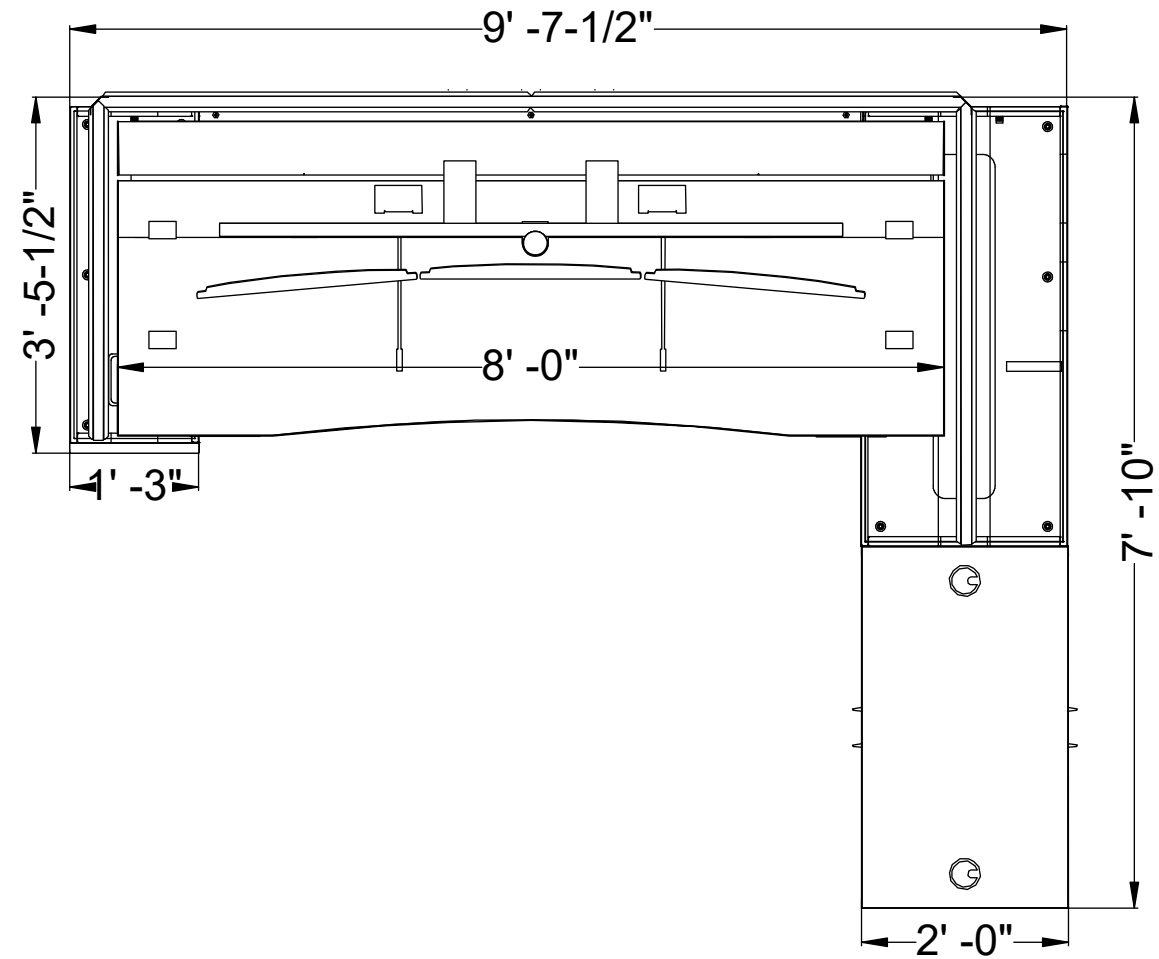

96" W Pro Worksurface

(OPTIONAL) Environmental Control

Dual Tier Monitor Array

Status Light

42" H Fabric Screens

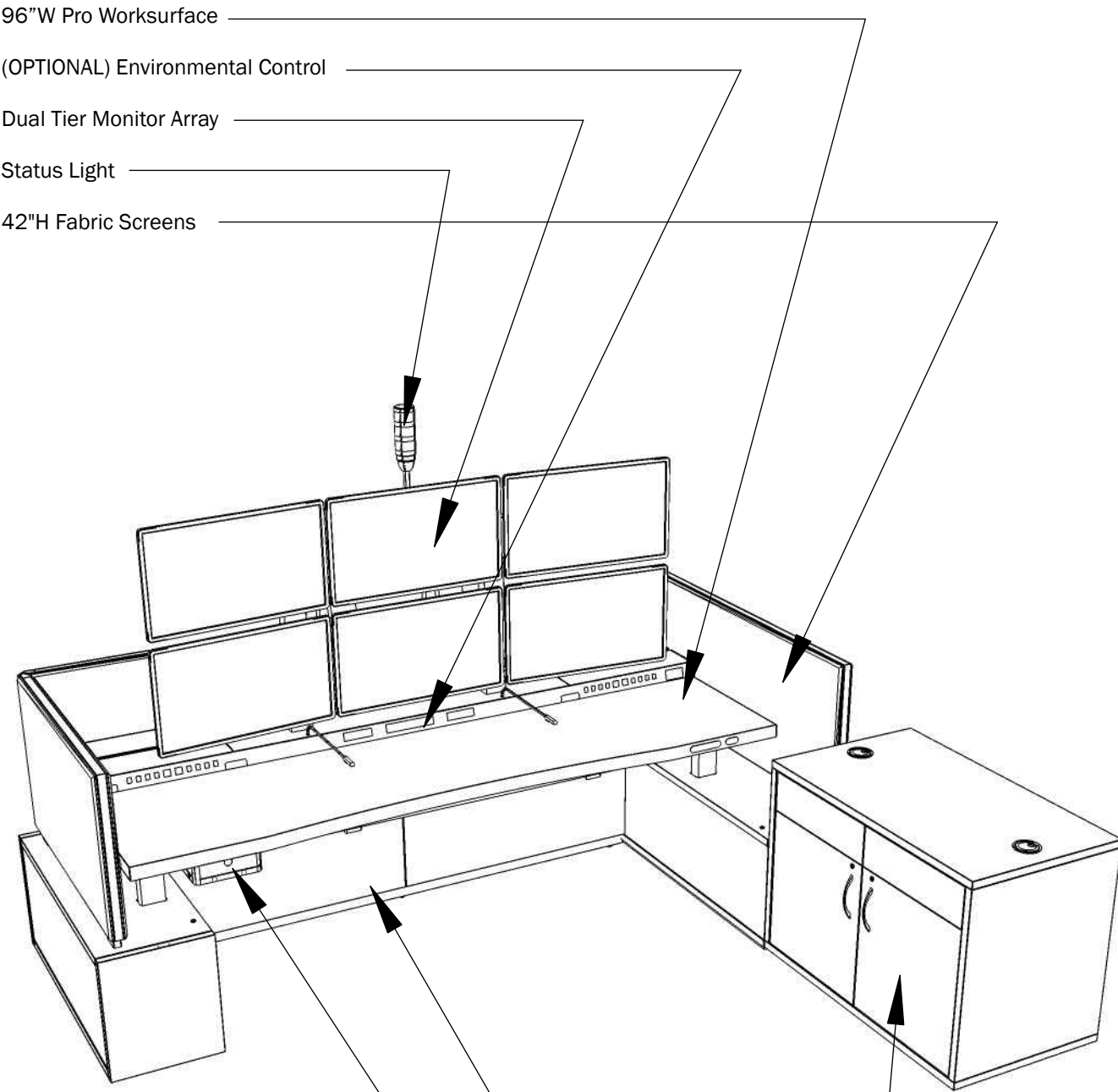

Technology Bridge Storage

Technology Cabinet

Pendant Drawer

Mercury Pro All Positions

Project

Johnson County, Texas

Proposal 1

Quote Revision: 11
Quote Date: 10/20/2023
Drawn By: KH

Watson Sales Rep

Jeff McClain

Watson Account Manager

Kelsey Hoskins

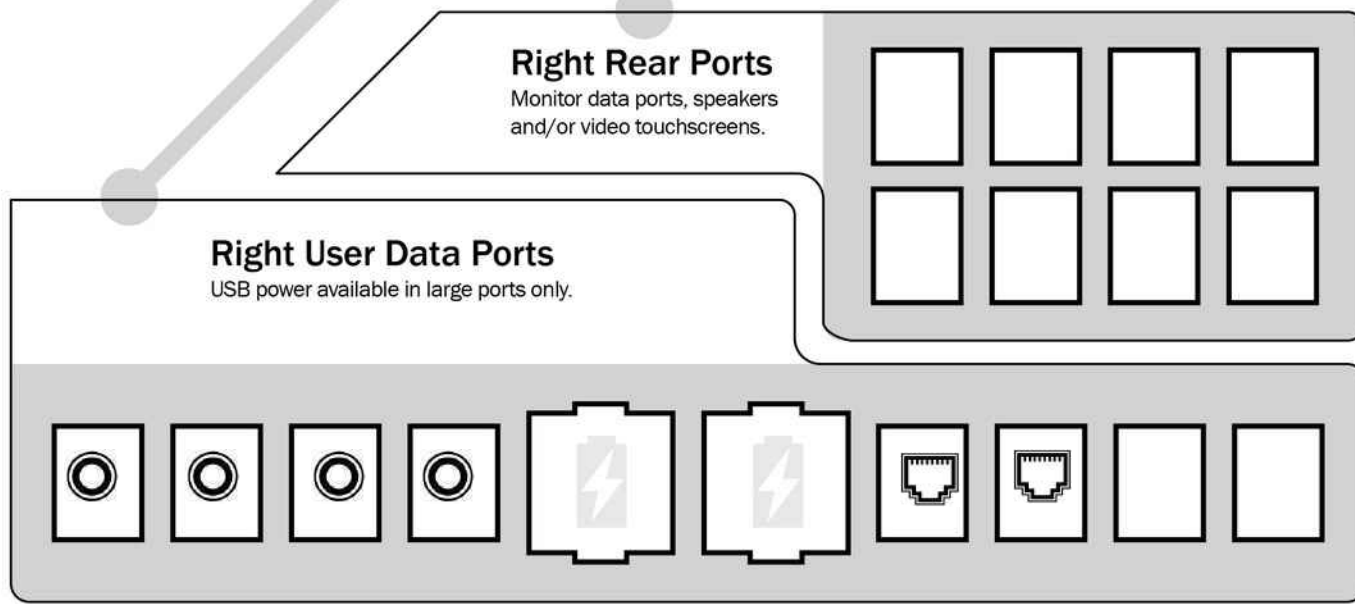
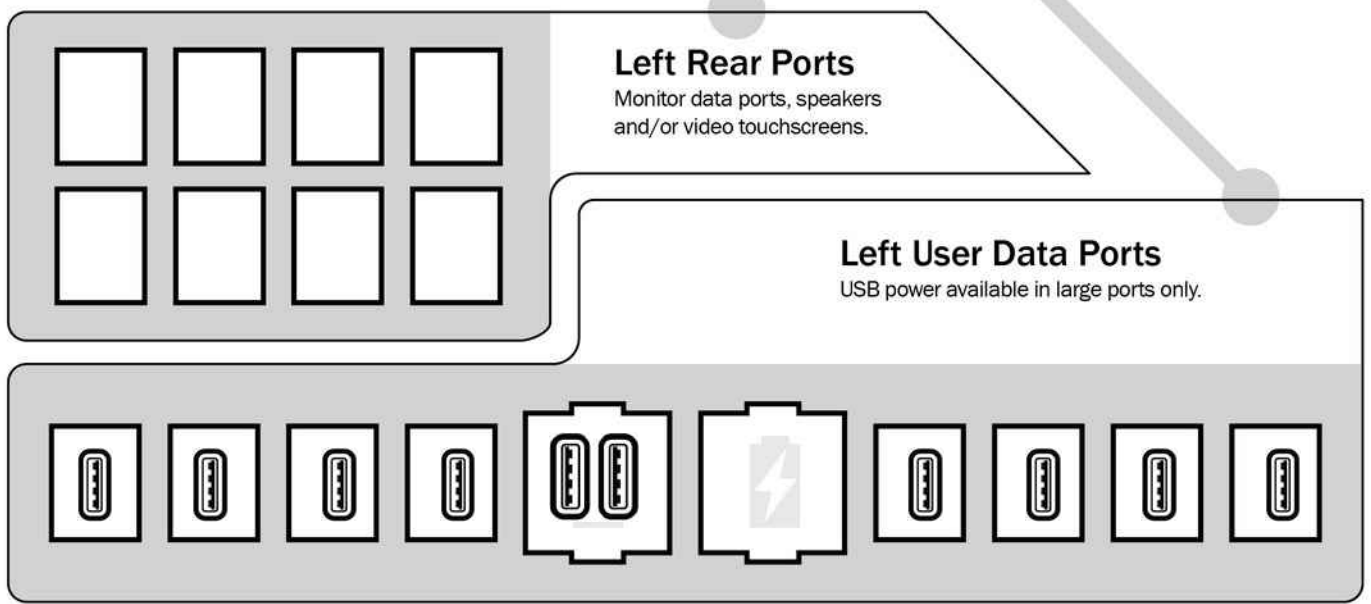
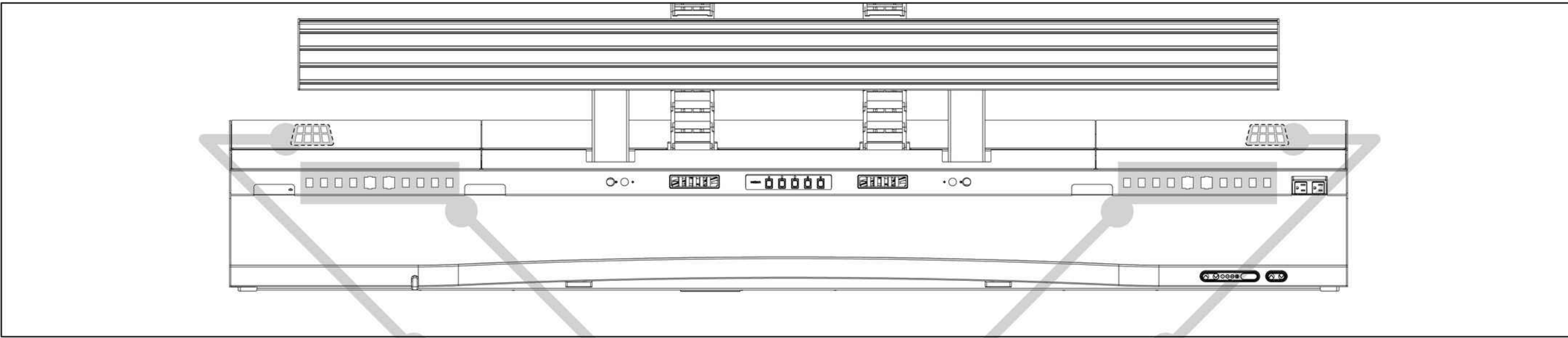

Data Port Types

<p>USB-A + USB-A Power Specified in large center ports only</p>	<p>USB-C + USB-A Power Specified in large center ports only</p>	<p>USB-A</p>	<p>USB-C</p>	<p>CAT6/RJ45</p>	<p>RJ12</p>	<p>3.5 Stereo</p>
--	--	---------------------	---------------------	-------------------------	--------------------	--------------------------

Optional features may be shown.

Proposal 1

Project: Johnson County, Texas

Sold to

Company name: Johnson County, Tx
 Contact Person: Keysha Hill
 Contact Phone: 8175566099
 Contact Fax: 8179071978

Distributor

Company name: Access Marketing
 Salesperson: Jeff McClain
 Salesperson Phone: 316-512-9022
 Salesperson Fax:



#	Qty	Part Number	Description	Sell	Ext. Sell
Dispatch Positions					
1	2	HD6H153918L-N	MERCURY PRO HUB, 15"D x 39"W x 18"H, LEFT HAND, NO GROMMET	\$2,064.00	\$4,128.00
2	2	HD6H153918R-N	MERCURY PRO HUB, 15"D x 39"W x 18"H, RIGHT HAND, NO GROMMET	\$2,064.00	\$4,128.00
3	8	HD6H245118C	MERCURY PRO HUB, 24"D x 51"W x 18"H, CENTER	\$3,907.20	\$31,257.60
4	2	HD6H245118L-G	MERCURY PRO HUB, 24"D x 51"W x 18"H, LEFT HAND, WITH GROMMET	\$2,431.20	\$4,862.40
5	2	HD6H245118R-G	MERCURY PRO HUB, 24"D x 51"W x 18"H, RIGHT HAND, WITH GROMMET	\$2,431.20	\$4,862.40
6	12	HD6W3696D	MERCURY PRO WORKSURFACE WITH DEPTH ADJUSTMENT, 36"D x 96"W x 24-50"H, WITH CONTOUR EDGE, DUAL TIER ARRAY	\$4,401.60	\$52,819.20
7	12	HG6TS96G	MERCURY TECH BRIDGE, SINGLE SIDED 12" D X 18"H, FOR A 96"W CONSOLE, WITH GROMMET	\$794.40	\$9,532.80
8	24	HGA	MERCURY ARRAY	\$1,358.40	\$32,601.60
9	2	HGBS1518D-L	MERCURY BRIDGE SPACER, 15"D x 18"H DUAL, LEFT HAND	\$57.60	\$115.20
10	2	HGBS1518D-R	MERCURY BRIDGE SPACER, 15"D x 18"H DUAL, RIGHT HAND	\$57.60	\$115.20
11	8	HGBS2418D-C	MERCURY BRIDGE SPACER, 24"D x 18"H DUAL, CENTER	\$83.04	\$664.32
12	2	HGBS2418D-L	MERCURY BRIDGE SPACER, 24"D x 18"H DUAL, LEFT HAND	\$83.04	\$166.08
13	2	HGBS2418D-R	MERCURY BRIDGE SPACER, 24"D x 18"H DUAL, RIGHT HAND	\$83.04	\$166.08
14	4	HGSOCBKT42L	MERCURY OUTSIDE CORNER BRACKET, 42"H	\$31.20	\$124.80
15	4	HGSOCBKT42R	MERCURY OUTSIDE CORNER BRACKET, 42"H	\$31.20	\$124.80
16	4	HGSR3942F	MERCURY RETURN SCREEN, 39"W x 42"H, ALL FABRIC PANEL	\$528.00	\$2,112.00
17	12	HGSR5142F	MERCURY RETURN SCREEN, 51"W x 42"H, ALL FABRIC PANEL	\$547.20	\$6,566.40
18	12	HGSS9642F	MERCURY SPINE SCREEN, 96"W x 42"H, ALL FABRIC PANEL	\$979.20	\$11,750.40
19	8	HGSWIBKT42	MERCURY WINGED BRACKET, 42"H	\$25.92	\$207.36
20	4	HGTB244230L	MERCURY TECHNOLOGY BASE, 24"D x 42"W x 30"H, LEFT HAND	\$1,771.20	\$7,084.80
21	2	HGTB244230L	MERCURY TECHNOLOGY BASE, 24"D x 42"W x 30"H, LEFT HAND	\$1,977.60	\$3,955.20
22	4	HGTB244230R	MERCURY TECHNOLOGY BASE, 24"D x 42"W x 30"H, RIGHT HAND	\$1,771.20	\$7,084.80
23	2	HGTB244230R	MERCURY TECHNOLOGY BASE, 24"D x 42"W x 30"H, RIGHT HAND	\$1,977.60	\$3,955.20
24	4	HHC1518	MERCURY HUB COVER, 15"D x 18"H	\$41.76	\$167.04
25	12	TXXHGDWR	MERCURY PENDANT DRAWER, FOR USE ON MERCURY PRO WORKSURFACES, 5.625"D X 12"W X 2.625"H	\$192.00	\$2,304.00
26	12	TXXSTATUS-3LPS	STATUS LIGHT R/Y/G WITH POWER SUPPLY	\$907.20	\$10,886.40
27	1	WAKEY-STD	MASTER KEY, STANDARD LOCK (082000)	\$24.00	\$24.00
				Total Dispatch Positions	\$201,766.08
Optional Items					
28	14	HAENVCON	MERCURY ENVIRONMENT CONTROL, RETROFIT FOR MERCURY PRO	\$2,112.00	\$29,568.00
29	14	TXX4X6GROUND	MERCURY, GROUND BAR KIT 4" X 6"	\$110.40	\$1,545.60
30	56	TXXTECHAUDIO25	TECH LINK, 3.5MM STEREO AUDIO JACK, BLACK, 25' CORD	\$25.92	\$1,451.52
31	28	TXXTECHDATA25	TECH LINK, CAT6 / RJ45, DATA, BLACK, 25' CORD	\$47.04	\$1,317.12
32	14	TXXTECHUSB-CHRG	TECH LINK, DUAL USB A, BLACK	\$105.60	\$1,478.40

Proposal 1

Project: Johnson County, Texas

Sold to

Company name: Johnson County, Tx
 Contact Person: Keysha Hill
 Contact Phone: 8175566099
 Contact Fax: 8179071978

Distributor

Company name: Access Marketing
 Salesperson: Jeff McClain
 Salesperson Phone: 316-512-9022
 Salesperson Fax:



#	Qty	Part Number	Description	Sell	Ext. Sell
33	112	TXXTECHUSB15	TECH LINK, SINGLE USB A, DATA, BLACK, 15' CORD	\$31.20	\$3,494.40
				Total Optional Items	\$38,855.04
Supervisor Positions					
34	1	HD6H153918L-N	MERCURY PRO HUB, 15"D x 39"W x 18"H, LEFT HAND, NO GROMMET	\$2,064.00	\$2,064.00
35	1	HD6H153918R-N	MERCURY PRO HUB, 15"D x 39"W x 18"H, RIGHT HAND, NO GROMMET	\$2,064.00	\$2,064.00
36	1	HD6H245118L-G	MERCURY PRO HUB, 24"D x 51"W x 18"H, LEFT HAND, WITH GROMMET	\$2,431.20	\$2,431.20
37	1	HD6H245118R-G	MERCURY PRO HUB, 24"D x 51"W x 18"H, RIGHT HAND, WITH GROMMET	\$2,431.20	\$2,431.20
38	2	HD6W3696D	MERCURY PRO WORKSURFACE WITH DEPTH ADJUSTMENT, 36"D x 96"W x 24-50"H, WITH CONTOUR EDGE, DUAL TIER ARRAY	\$4,401.60	\$8,803.20
39	2	HG6TS96G	MERCURY TECH BRIDGE, SINGLE SIDED 12" D X 18"H, FOR A 96"W CONSOLE, WITH GROMMET	\$794.40	\$1,588.80
40	4	HGA	MERCURY ARRAY	\$1,358.40	\$5,433.60
41	1	HGBS1518D-L	MERCURY BRIDGE SPACER, 15"D x 18"H DUAL, LEFT HAND	\$57.60	\$57.60
42	1	HGBS1518D-R	MERCURY BRIDGE SPACER, 15"D x 18"H DUAL, RIGHT HAND	\$57.60	\$57.60
43	1	HGBS2418D-L	MERCURY BRIDGE SPACER, 24"D x 18"H DUAL, LEFT HAND	\$83.04	\$83.04
44	1	HGBS2418D-R	MERCURY BRIDGE SPACER, 24"D x 18"H DUAL, RIGHT HAND	\$83.04	\$83.04
45	2	HGSOCBKT42L	MERCURY OUTSIDE CORNER BRACKET, 42"H	\$31.20	\$62.40
46	2	HGSOCBKT42R	MERCURY OUTSIDE CORNER BRACKET, 42"H	\$31.20	\$62.40
47	2	HGSR3942F	MERCURY RETURN SCREEN, 39"W x 42"H, ALL FABRIC PANEL	\$528.00	\$1,056.00
48	2	HGSR5142F	MERCURY RETURN SCREEN, 51"W x 42"H, ALL FABRIC PANEL	\$547.20	\$1,094.40
49	2	HGSS9642F	MERCURY SPINE SCREEN, 96"W x 42"H, ALL FABRIC PANEL	\$979.20	\$1,958.40
50	1	HGTB244230L	MERCURY TECHNOLOGY BASE, 24"D x 42"W x 30"H, LEFT HAND	\$1,977.60	\$1,977.60
51	1	HGTB244230R	MERCURY TECHNOLOGY BASE, 24"D x 42"W x 30"H, RIGHT HAND	\$1,977.60	\$1,977.60
52	2	HHC1518	MERCURY HUB COVER, 15"D x 18"H	\$41.76	\$83.52
53	2	TXXHGDWR	MERCURY PENDANT DRAWER, FOR USE ON MERCURY PRO WORKSURFACES, 5.625"D X 12"W X 2.625"H	\$192.00	\$384.00
54	2	TXXSTATUS-3LPS	STATUS LIGHT R/Y/G WITH POWER SUPPLY	\$907.20	\$1,814.40
55	1	WAKEY-STD	MASTER KEY, STANDARD LOCK (082000)	\$24.00	\$24.00
				Total Supervisor Positions	\$35,592.00

Product Subtotal	\$276,213.12
Installation	\$40,764.00
Freight	\$8,840.00
Total	\$325,817.12
Sales Tax; Cleburne, TX (8.25 %)	\$26,879.91
Grand Total	\$352,697.03